

TYPE "A"
 IMPROVED ASPHALTIC CONCRETE
 OR PLANT-MIX CONCRETE STREETS

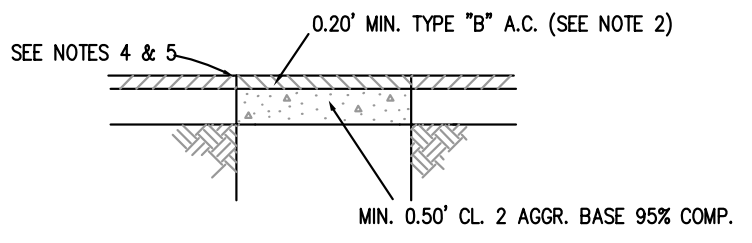

TYPE "B"
 IMPROVED ARMOR COAT
 OR SEAL COAT STREETS

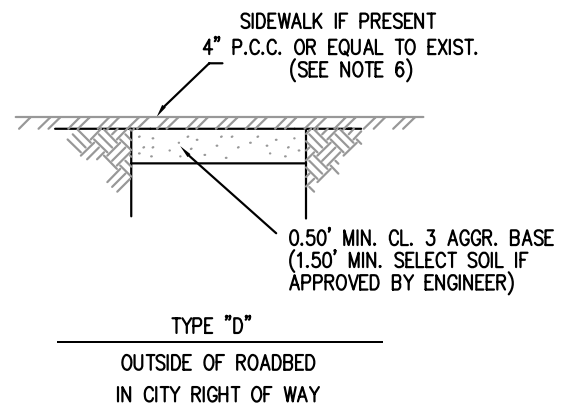
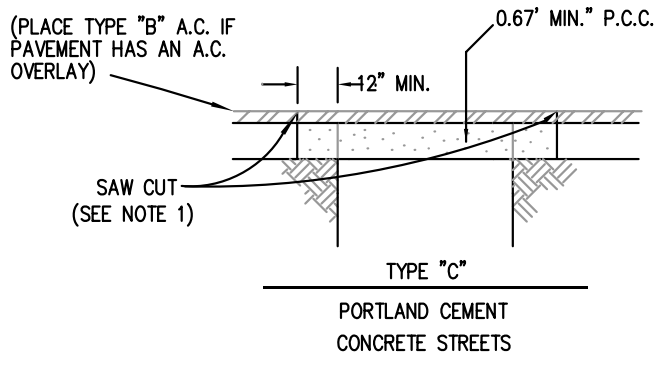

NOTES:

1. TYPE "A" & "C" SURFACES REQUIRE (2) TWO CUTS; FIRST CUT INITIAL TRENCH WIDTH THEN AFTER WORK HAS BEEN COMPLETED, IT SHALL BE SAW CUT A MINIMUM OF 12" WIDER BOTH SIDES.
2. TYPE "A" & "B" TRENCHES REQUIRE PLACEMENT AND MAINTENANCE OF TEMPORARY PAVEMENT (SC-800 COLD MIX), COMPACTED IN PLACE USING A VIBRATING ROLLER OR VIBROPLATE, FOR A MINIMUM OF 30 DAYS PRIOR TO PERMANENT PAVING.
3. STRUCTURAL THICKNESS SHOWN ARE MINIMUM ALLOWABLE. OVER THICKNESS OF STRUCTURAL SECTIONS MAY BE REQUIRED BY CITY ENGINEER IF EXISTING STRUCTURAL SECTION EXCEEDS THESE MINIMUMS.
4. FINAL RESTORATION OF TYPE "B" TRENCHES WILL BE AGAINST A SAW CUT LINE.
5. PAVING SURFACE AT TRENCH JOINTS SHALL BE SEALED WITH ASPHALT EMULSION 4" EACH SIDE OF JOINT AFTER FINAL COMPACTION OF ASPHALT CONCRETE. SEALANT SHALL BE SANDED AS NECESSARY TO PREVENT TRAFFIC PICKUP.
6. SIDEWALKS SHALL BE REMOVED TO EXISTING JOINTS OR SAW CUT TO EXISTING SCORE LINES. SCORE LINES IN NEW CONCRETE SHALL MATCH EXISTING.



DEPARTMENT OF CITY SERVICES

STANDARD DETAIL 502

APPROVED _____

DATE _____

Surface Resoration